



Notice to Navigation Interests

US Army Corps
of Engineers
Buffalo District
1776 Niagara Street
Buffalo, New York 14207-3199

L09-09	JUNE 8, 2009
Notice No.	Date
<hr/>	
Waterway	

Lake Ontario, New York

LRB-TD-ONS



Condition of Federal Navigation Channel Rochester Harbor, New York

1. Condition surveys performed within the Federal navigation Channel at Rochester Harbor, New York during the month of March and April 2009 indicate shoaling has reduced depths to those shown on the attached standard tabular form and channel condition drawings.
2. Soundings are in feet and referred to Low Water Datum (LWD) 243.3 feet above Mean Water Level (MWL) at Rimouski, Quebec (International Great Lakes Datum 1985).
3. Vessel operators are advised to use caution when navigating in this area.
4. Copies of the sounding print for Rochester Harbor, New York consisting of (2) sheets, 09S-ROC-1/1 and 1/2, at a cost of \$2.50 per sheet will be furnished upon receipt of a check in the full amount made payable to: United States Army Engineer District, Buffalo. Requests should be addressed to: District Commander, U.S. Army Engineer District, Buffalo, ATTN: NY/PA O&M Office, 1776 Niagara Street, Buffalo, New York 14207, requesting exact number or copies of sheets by file number. A point of contact and phone number must be indicated to facilitate response to the request. To download the same information and other related materials at no cost, simply point your web browsers to <http://www.lrb.usace.army.mil/WhoWeAre/WaterMgmt/survey/survey.html> click on the year and then locate the harbor on the table of harbors.
5. Buffalo District's point of contact in reference to the exact number of sheets, file number, and the availability of any later information pertaining to the area is Mr. Roman H. Figler III, Chief of the Survey Section, Buffalo District, and may be contacted by phone at 716-879-4429.

RAYMOND N. LEWIS
Chief, NY/PA Operations and
Maintenance Office

**REPORT OF CHANNEL CONDITIONS
(FOR CHANNELS LESS THAN 400 FEET WIDE)
(ER-1330-2-316)**

PAGE 2 OF 4 PAGES

DATE JUNE 8, 2009

TO: ACCOMPANY LOCAL NOTICE TO NAVIGATION INTERESTS, DATED 

FROM: U.S. ARMY CORPS OF ENGINEERS, BUFFALO DISTRICT
1776 NIAGARA STREET, BUFFALO, NY 14207-3199
(716) 879-4292 FAX (716) 879-4357

RIVER/HARBOR NAME AND STATE
ROCHESTER HARBOR, ROCHESTER, OHIO

MINIMUM DEPTHS IN CHANNEL ENTERING FROM SEAWARD

NAME OF CHANNEL	DATE OF SURVEY	AUTHORIZED PROJECT			LEFT OUTSIDE QUARTER (feet)	MIDDLE HALF (feet)	RIGHT OUTSIDE QUARTER (feet)
		WIDTH (feet)	LENGTH (feet)	DEPTH (feet)			
(A) LAKE APPROACH CHANNEL.	MARCH APRIL 2009	300	2800 (a)	22	18.4	18.6	18.5
(B) ENTRANCE CHANNEL.	MARCH APRIL 2009	200-600	4400 (b)	21	13.1	17.0	13.4
(C) LOWER TURNING BASIN.	MARCH APRIL 2009	200-600	4400 (b)	21	3.7	5.7	13.4
(D) GENESEE RIVER.	MARCH APRIL 2009	150-270	10800 (c)	21	10.6	3.0	3.0
(E) UPPER TURNING BASIN.		0-500	800 (b)	*		NOT SOUNDED	
(F) GENESEE RIVER, UPSTREAM 1200 FEET OF NAVIGATION.	MARCH APRIL 2009	150	1200	*	10.9	11.4	12.3
(G) UPPER TURNING BASIN	MARCH APRIL 2009	0-200	1150 (b)	21	3.9	4.6	15.8

REMARKS: * NOT MAINTAINED, (a) LENGTH VARIES DEPENDING ON THE LOCATION OF THE 22 FOOT CONTOUR IN LAKE ONTARIO. (b) IRREGULARLY SHAPED, SEE PROJECT CONDITION DRAWINGS.(C) WINDING RIVER CHANNEL, NARROWS AT BRIDGES.

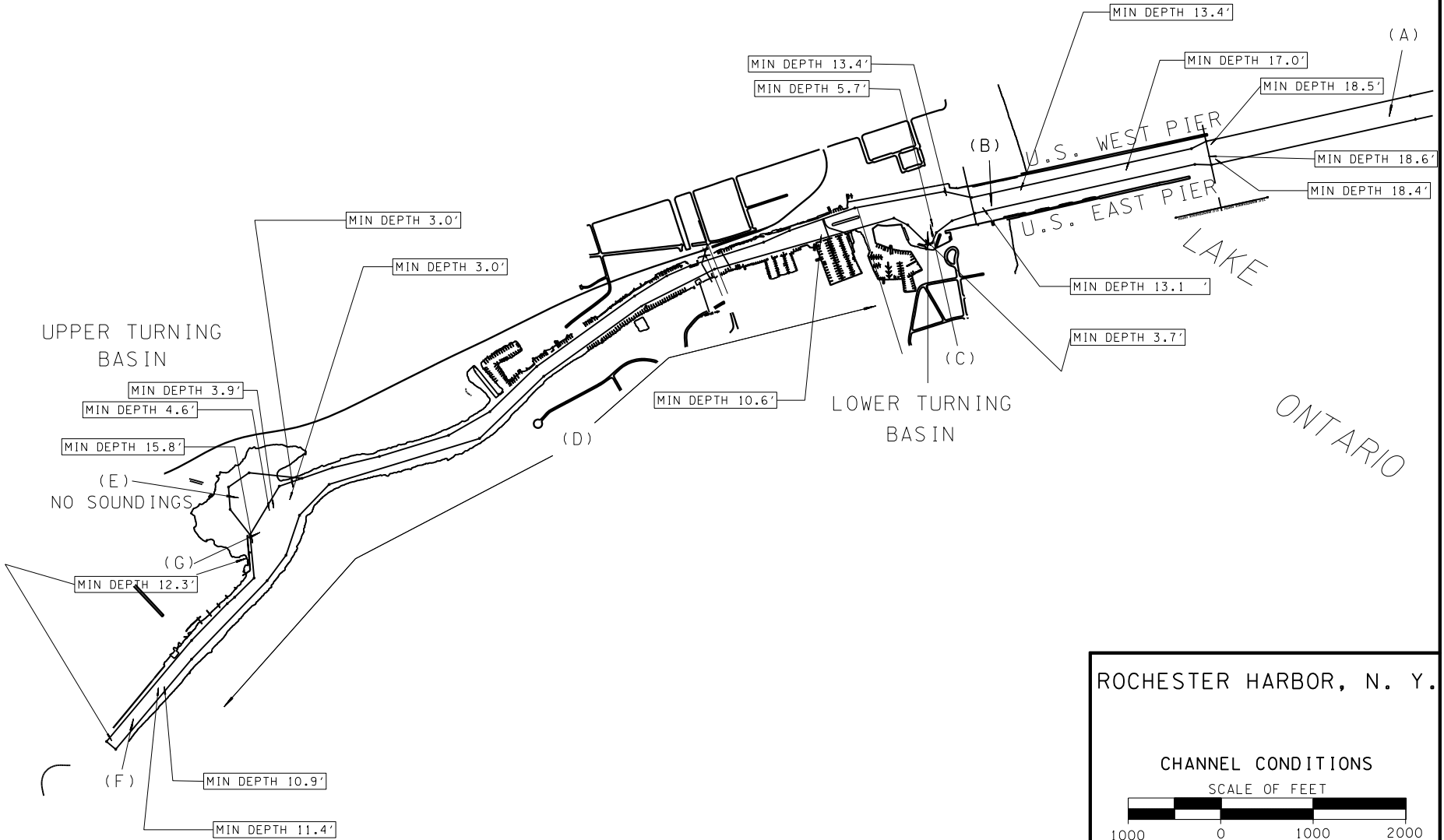
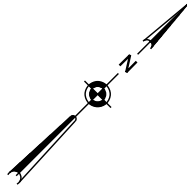





ROCHESTER HARBOR, N. Y.

CHANNEL CONDITIONS

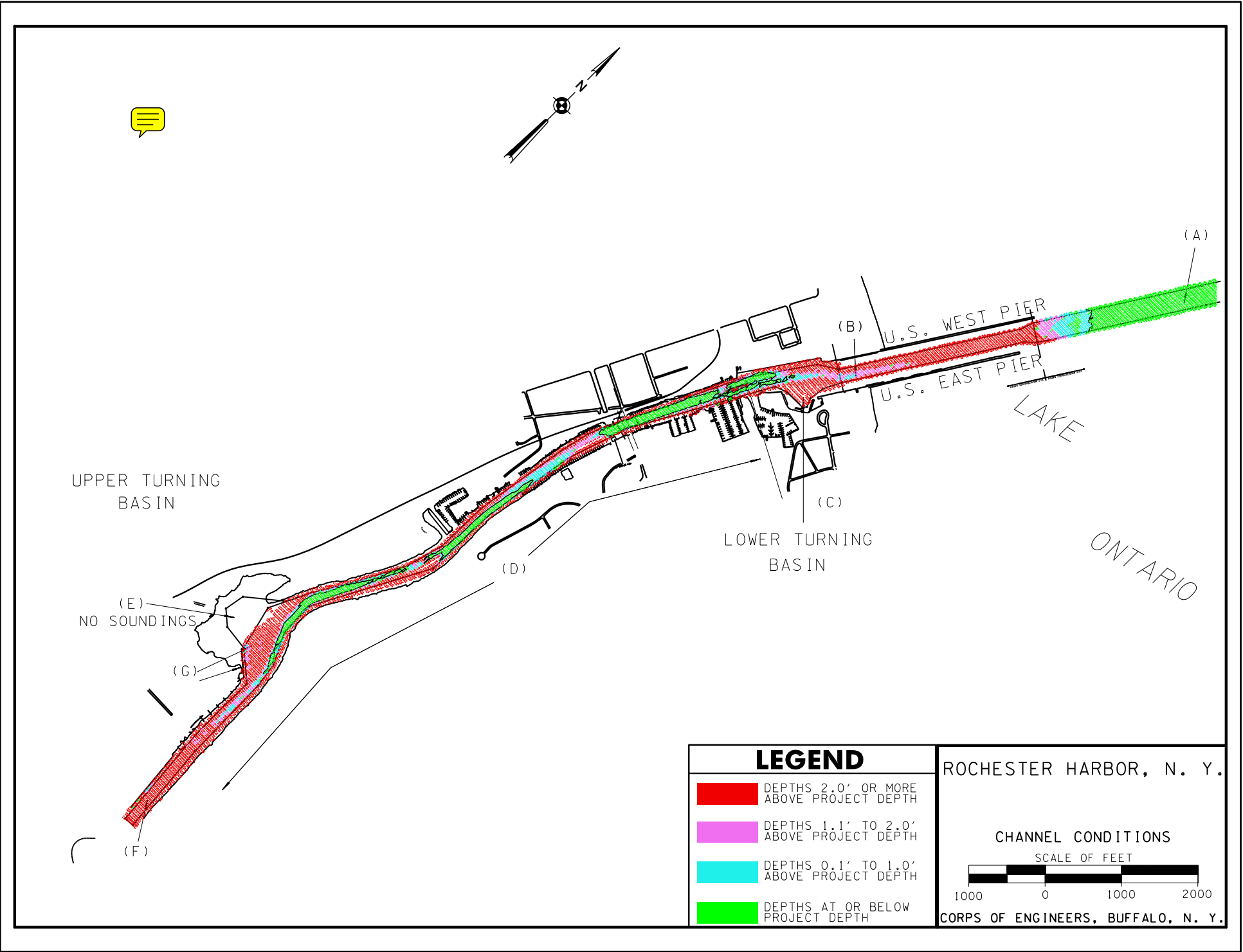
SCALE OF FEET

CORPS OF ENGINEERS, BUFFALO, N. Y.



LEGEND	
	DEPTHS 2.0' OR MORE ABOVE PROJECT DEPTH
	DEPTHS 1.1' TO 2.0' ABOVE PROJECT DEPTH
	DEPTHS 0.1' TO 1.0' ABOVE PROJECT DEPTH
	DEPTHS AT OR BELOW PROJECT DEPTH

ROCHESTER HARBOR, N. Y.

CHANNEL CONDITIONS

SCALE OF FEET

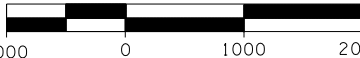

CORPS OF ENGINEERS, BUFFALO, N. Y.