

CITY OF TONAWANDA, NEW YORK

OFFICE OF THE MAYOR

200 Niagara Street Tonawanda, New York 14150 - 1099
Phone: (716) 695 - 8645 Fax: (716) 695 - 8314
E-mail: mayor@ci.tonawanda.ny.us

[REDACTED]
Mayor

[REDACTED]
Administrative Assistant

[REDACTED]
Executive Secretary

February 5, 2007

[REDACTED]
Supervisor
Town of Tonawanda
2919 Delaware Ave,
Kenmore, NY 14217

RE: Closure and Reuse of Town of Tonawanda Landfill Site

Dear Supervisor [REDACTED]

As the Town of Tonawanda works through the many issues related to the Town's efforts to close and cap the Town Landfill adjacent to the southwest section of the City of Tonawanda, I am asking that you place a high priority on the eventual reuse and redevelopment of the site. The Town's own Master Plan, as well as your Brownfield Opportunity Area Program grant application include the concept of redeveloping this landfill area as a recreational facility such as a nine-hole golf course or as passive recreation. Most importantly, these reuse plans call for a roadway through this area connecting the Spaulding site in the City with the Youngmann Commerce site in the Town.

I believe a roadway, installed between the start of the northern slop of the landfill cap and the south City line, that runs east and west, parallel to the residential properties on Hackett Drive, as pictured in the attached photo/document produced by the Town, will provide a buffer between the landfill and the backyards of residential homes on Hackett Drive in the City. I also believe this roadway buffer could address a number of the issues and concerns about the landfill that are currently being raised by residents who live on Hackett Drive and the surrounding neighborhood.

Your consideration and implementation of this request would be greatly appreciated. Please fell free to contact me if you have any questions.

[REDACTED]

TON_00101

CC:



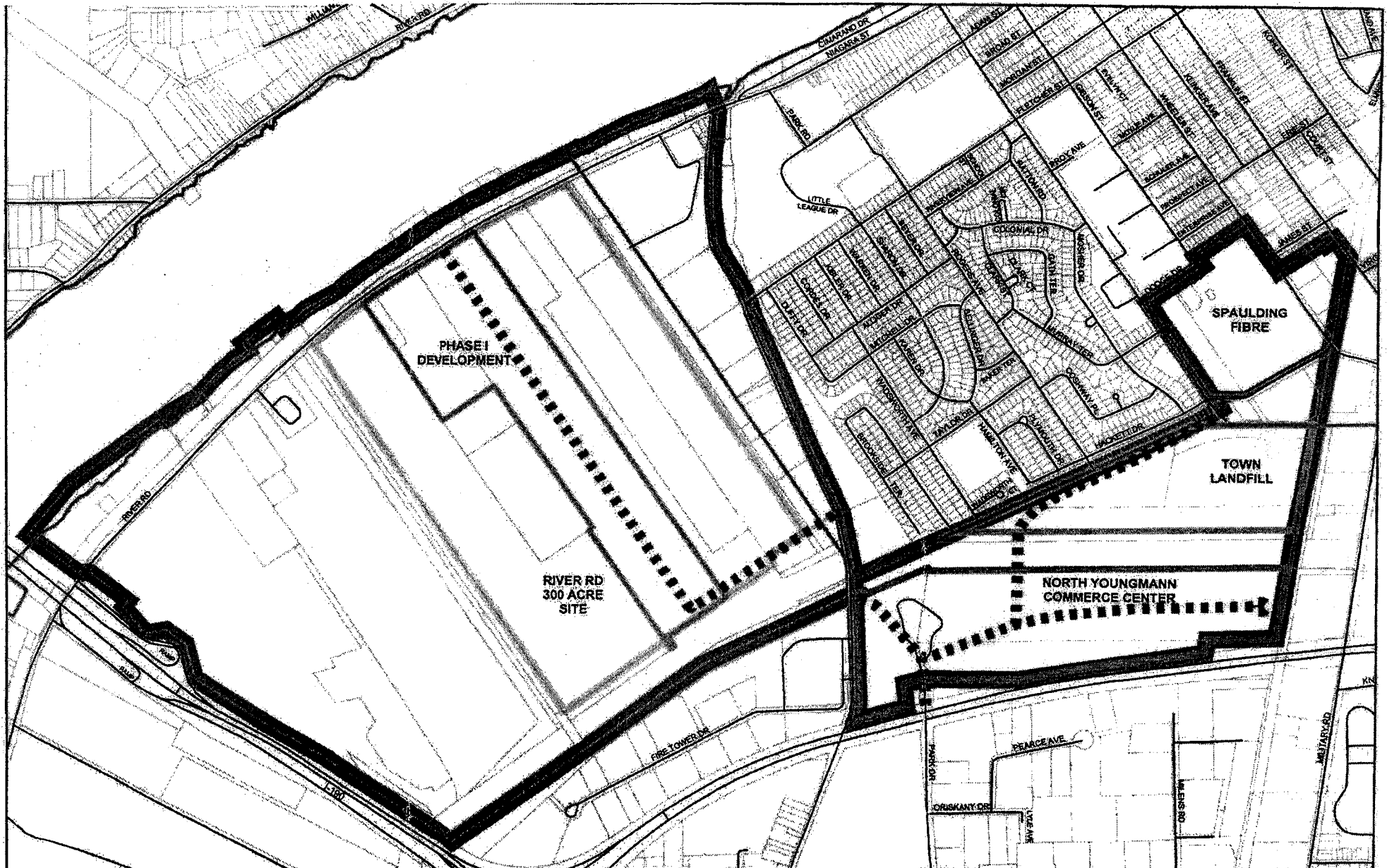

Erie County
Maps

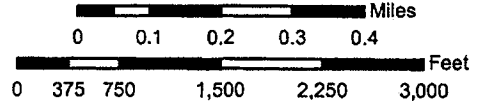

Tonawanda Brownfield Opportunity

-  Brownfield Opportunity Area
-  Spaulding Fibre
-  N Youngmann Commerce Ctr
-  Town Landfill
-  River Rd 300 Acre Site
-  Phase 1 Development
-  Proposed Roadways