

SOUNDING COLOR LEGEND

■	DEPTHS 0.1' OR MORE ABOVE PROJECT DEPTH
■	DEPTHS AT OR BELOW PROJECT DEPTH
XX.X	PROJECT DEPTH

LEGEND OF SYMBOLS

17+00 (NEW)	CHANNEL STATIONING
o 417	CHANNEL CORNER
⊙ H.L.F.	HARBOR LINE CORNER
----	FEDERAL CHANNEL
----	HARBOR LINE
----	SUBMARINE CABLE
⊙	CAN BUOY
⊙	NUN BUOY
⊙	LIGHTED BUOY
⊙	FIXED LIGHT
⊙	LIGHT HOUSE
W	LIGHT COLOR WHITE
R	LIGHT COLOR RED
G	LIGHT COLOR GREEN
FL	FLASHING LIGHT
F	FIXED LIGHT
Oc	OCCULTING LIGHT
Iso	EQUAL INTERVAL
AL	ALTERNATING
Q	QUICK (FLASHING)
S	LIGHT CYCLE SECONDS

SITE SPECIFIC NOTES:

1. PROJECT DEPTHS AND SOUNDINGS ARE REFERRED TO LOW WATER DATUM OF 242.7 FEET IGLD 1985.
2. HORIZONTAL CONTROL IS REFERRED TO NORTH AMERICAN DATUM 1983 NEW YORK STATE PLANE COORDINATE SYSTEM-EAST ZONE.
3. PROJECT DEPTH IS AS NOTED BELOW LOW WATER DATUM.
4. SOUNDINGS WERE TAKEN BY THE BUFFALO DISTRICT ARMY CORPS OF ENGINEERS BY D. BANNING AND PARTY ON JUNE 8, 2016 USING:
CORRECTIONS USED: RTK TIDES
SONAR HEAD: 200/24KHZ, ODOM ECHOTRACK MKIII
3 DEGREE
VELOCITY PROFILER: SONTEK CASTAWAY
HYPACK SURVEY SOFTWARE
SURVEY LAUNCH: JET BOAT
5. THE SOUNDING INFORMATION DEPICTED ON THE MAP REPRESENTS THE RESULTS OF SURVEYS MADE ON THE DATE INDICATED AND CAN ONLY BE CONSIDERED AS INDICATING THE GENERAL CONDITION AT THAT TIME.
6. THE TOPOGRAPHIC INFORMATION IS BASED ON AERIAL PHOTOGRAPHY ACQUIRED FROM 1998 THROUGH 2004.
7. THIS SURVEY WAS PREPARED IN ACCORDANCE WITH THE STANDARDS OUTLINED IN CORPS OF ENGINEERS HYDROGRAPHIC SURVEY MANUAL EM 1110-2-1003.

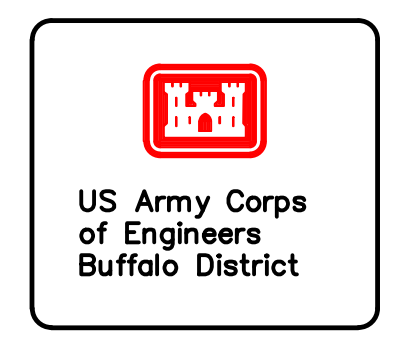

	Original sheet size = ANSI D

**** COPY OF SIGNED ORIGINAL ****

Drawn by: KFL
Checked by: ACK
Reviewed by: Roman H. Figler III PLS
Chief, Survey Section
Approved by: Edward F. Gowerrecki
Date: June 15, 2016
Chief, NY/PA Navigation and Maintenance Section
<http://www.fusources.army.mil/Library/NavigationCharts.aspx>

**U.S. ARMY ENGINEER DISTRICT
CORPS OF ENGINEERS
BUFFALO, NEW YORK 14207-3199**

MORRISTOWN HARBOR, NY
PROJECT CONDITIONS SOUNDINGS 2016
SCALE: 1"=50'

Sheet reference number
VH-101
Sheet 1 of 1

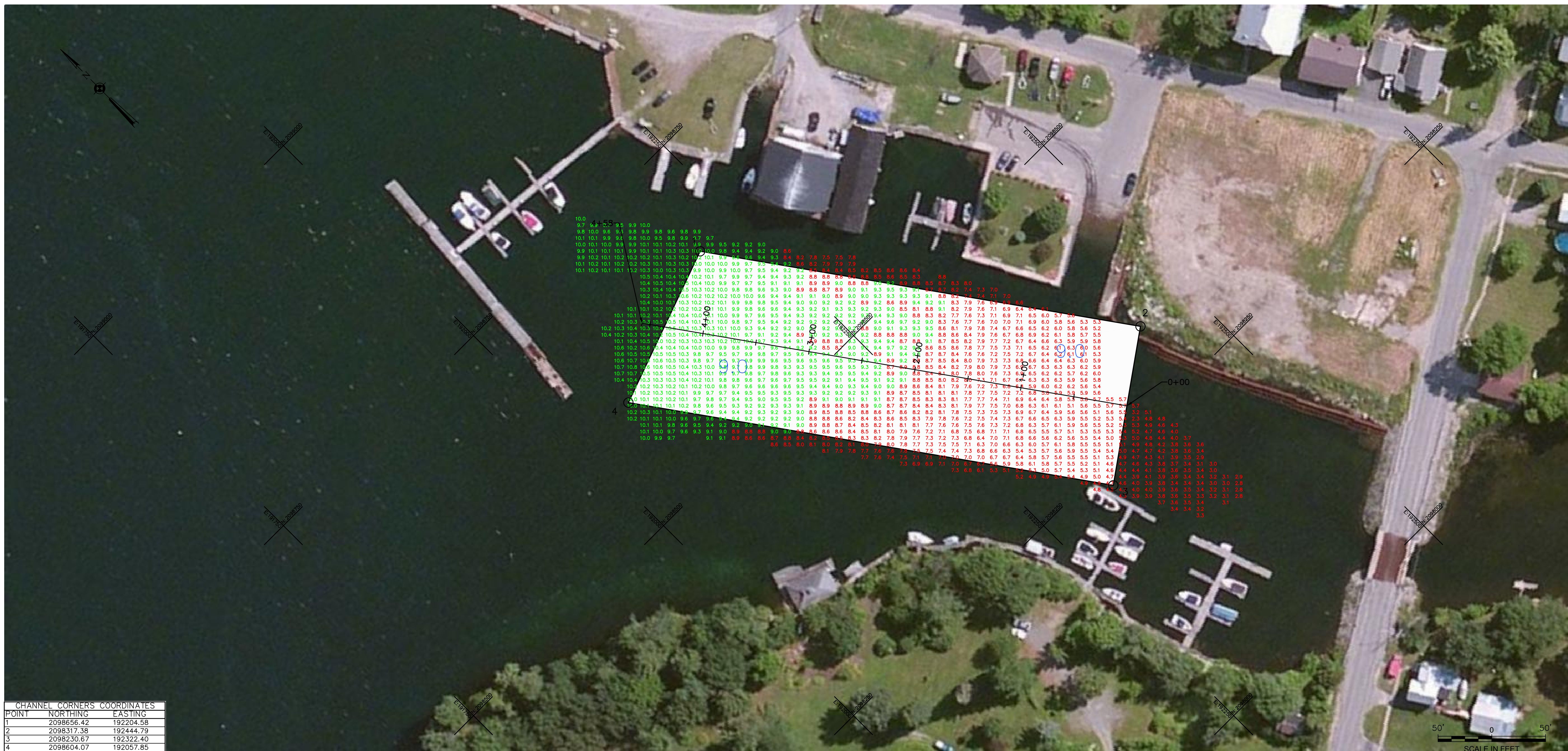

CHANNEL CORNERS COORDINATES

POINT	NORTHING	EASTING
1	2098656.42	192204.58
2	2098317.38	192444.79
3	2098230.67	192322.40
4	2098604.07	192057.85