



Notice to Navigation Interests

US Army Corps
of Engineers
Buffalo District
1776 Niagara Street
Buffalo, New York 14207-3199

L 18-30	July 20, 2018
Notice No.	Date
Waterway	

Lake Erie, New York

LRB-TD-ONS

Condition of Federal Navigation Channel Niagara River, Niagara Falls, New York

1. Condition surveys performed within the Federal Navigation Channel at Niagara River, New York during the months of July 2018 indicate shoaling has reduced depths to those shown on the attached standard tabular form and channel condition drawings.
2. Soundings are in feet and referred to Low Water Datum (LWD) above Mean Water Level (MWL) at Rimouski, Quebec (International Great Lakes Datum 1985). LWD elevations for this area are based on decreasing graduated planes as shown on sheets 3 and 4 of this document.
3. Vessel operators are advised to use caution when navigating in this area.
4. Copies of the sounding print for Niagara River, New York consisting of (7) sheets, Niag18VH101to107, at a cost of \$2.50 per sheet will be furnished upon receipt of a check in the full amount made payable to: USACE Finance and Accounting. Requests should be addressed to: District Commander, U.S. Army Engineer District, Buffalo, ATTN: NY/PA O&M Office, 1776 Niagara Street, Buffalo, New York 14207, requesting exact number or copies of sheets by file number. A point of contact and phone number must be indicated to facilitate response to the request. To download the same information and other related materials at no cost, simply point your web browser to <http://www.lrb.usace.army.mil/Library/MapsandCharts.aspx> then locate the harbor on the table of harbors and click on the file icon to see or down load the file.
5. Buffalo District's point of contact in reference to the exact number of sheets, file number, and the availability of any later information pertaining to the area is Mr. Roman H. Figler III, PLS, Chief, Survey Section, Buffalo District, who may be contacted by phone at 716-879-4429.

FIGLER.ROM
AN.H.III.1384
329531

Digitally signed by
FIGLER.ROMAN.H.III.1384329531
DN: c=US, o=U.S. Government,
ou=DoD, ou=PKI, ou=USA,
cn=FIGLER.ROMAN.H.III.13843295
31
Date: 2018.07.21 06:53:40 -04'00'

Mr. ROMAN H. FIGLER III, PLS
Chief, Survey Section
NY/PA Operations and Maintenance Office

**REPORT OF CHANNEL CONDITIONS
(FOR CHANNELS LESS THAN 400 FEET WIDE)
(ER-1330-2-316)**

PAGE 2 OF 4 PAGES

DATE: July 20, 2018

TO: ACCOMPANY LOCAL NOTICE TO NAVIGATION INTERESTS

FROM: U.S. ARMY CORPS OF ENGINEERS, BUFFALO DISTRICT
1776 NIAGARA STREET, BUFFALO, NY 14207-3199
(716) 879-4292 FAX (716) 879-4356

RIVER/HARBOR NAME AND STATE
NIAGARA RIVER, NEW YORK

MINIMUM DEPTHS IN CHANNEL ENTERING FROM SEAWARD

NAME OF CHANNEL	DATE OF SURVEY	AUTHORIZED PROJECT			LEFT OUTSIDE QUARTER (feet)	MIDDLE HALF (feet)	RIGHT OUTSIDE QUARTER (feet)
		WIDTH (feet)	LENGTH (feet)	DEPTH (feet)			
(A) NIAGARA RIVER CHANNEL	July 2018	300	33500	12*	>12	>12	11.5
(B) NIAGARA FALLS CITY DOCK AREA	July 2018	300-400	650	12*	>12		

FOOT NOTES

REMARKS: * NOT MAINTAINED

(>) DEPTHS SHOWN WITH A > SIGN INDICATE THAT EXISTING MINIMUM DEPTHS MEET OR EXCEED THE AUTHORIZED PROJECT DEPTH



Niagara River, NY
 CHANNEL CONDITIONS
 SCALE IN FEET
 2000' 0 2000'
 CORPS OF ENGINEERS, BUFFALO, N. Y.

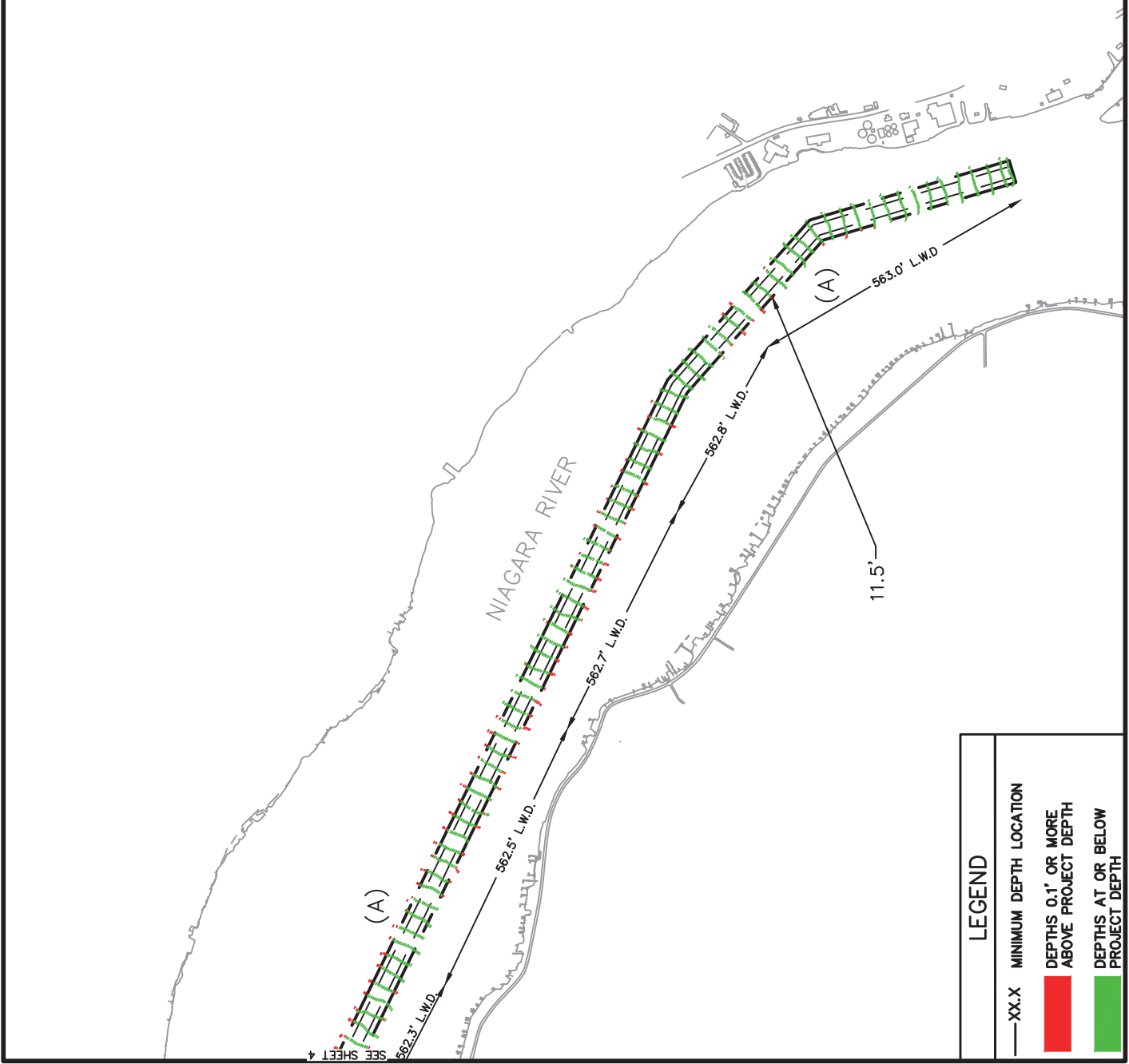

LEGEND	
—XX.X	MINIMUM DEPTH LOCATION
█	DEPTHS 0.1' OR MORE ABOVE PROJECT DEPTH
█	DEPTHS AT OR BELOW PROJECT DEPTH

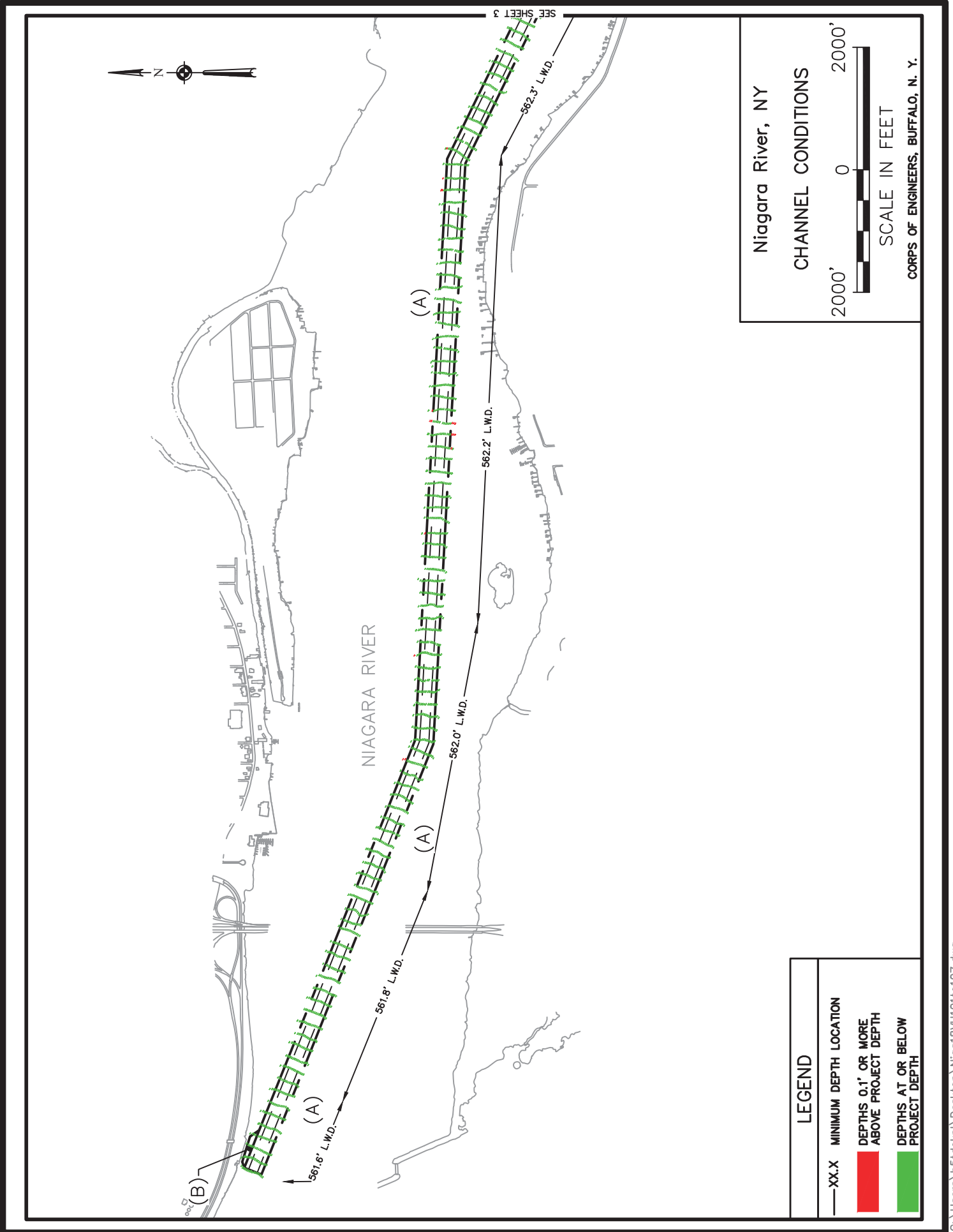

Niagara River, NY
 CHANNEL CONDITIONS
 SCALE IN FEET
 CORPUS OF ENGINEERS, BUFFALO, N. Y.

LEGEND	
—XX.X	MINIMUM DEPTH LOCATION
█	DEPTHS 0.1' OR MORE ABOVE PROJECT DEPTH
█	DEPTHS AT OR BELOW PROJECT DEPTH