

SOUNDING COLOR LEGEND
DEPTHS 0.1' OR MORE ABOVE PROJECT DEPTH (Red)
DEPTHS AT OR BELOW PROJECT DEPTH (Green)
18.0 PROJECT DEPTH

LEGEND OF SYMBOLS
17+00 CHANNEL STATIONING
417 CHANNEL CORNER
H.L.F. HARBOR LINE CORNER
FEDERAL CHANNEL
HARBOR LINE
SUBMARINE CABLE
CAN BUOY
NUN BUOY
LIGHTED BUOY
FIXED LIGHT
LIGHT HOUSE
W LIGHT COLOR WHITE
R LIGHT COLOR RED
G LIGHT COLOR GREEN
FL FLASHING LIGHT
F FIXED LIGHT
Oc OCCULTING LIGHT
Iso EQUAL INTERVAL
AL ALTERNATING
Q QUICK (FLASHING)
S LIGHT CYCLE SECONDS

SITE SPECIFIC NOTES:

- 1. PROJECT DEPTHS AND SOUNDINGS ARE REFERRED TO LOW WATER DATUM OF 243.3 FEET IGLD 1985.
2. HORIZONTAL CONTROL IS REFERRED TO NORTH AMERICAN DATUM 1983 NEW YORK STATE PLANE COORDINATE SYSTEM-CENTRAL ZONE.
3. PROJECT DEPTH IS AS NOTED BELOW LOW WATER DATUM.
4. SOUNDINGS WERE TAKEN BY THE BUFFALO DISTRICT ARMY CORPS OF ENGINEERS BY D. DELL AND PARTY ON APRIL 28, 2014 THROUGH APRIL 29, 2014 USING: GPS POSITIONING, POS-MV VER.5 CORRECTION USED; TRIMBLE RTK BASE AT CP"D" SONAR HEAD: 240 KHZ, SEABAT 7101 MULTIBEAM 1.5 DEGREE BEAMS 210 DEGREE ARC HEAVE PITCH AND ROLL; APPLANIX POS-MV VER. 5 VELOCITY PROFILER; SONTEK CASTAWAY CTD HYPACK SURVEY SOFTWARE SURVEY VESSEL "WITMER"
5. THE SOUNDING INFORMATION DEPICTED ON THE MAP REPRESENTS THE RESULTS OF SURVEYS MADE ON THE DATE INDICATED AND CAN ONLY BE CONSIDERED AS INDICATING THE GENERAL CONDITION AT THAT TIME.
6. THE BACKGROUND IMAGERY SHOWN WAS ACQUIRED FROM THE NEW YORK STATE GIS CLEARINGHOUSE.
7. THIS SURVEY WAS PREPARED IN ACCORDANCE WITH THE STANDARDS OUTLINED IN CORPS OF ENGINEERS HYDROGRAPHIC SURVEY MANUAL EM 1110-2-1003.

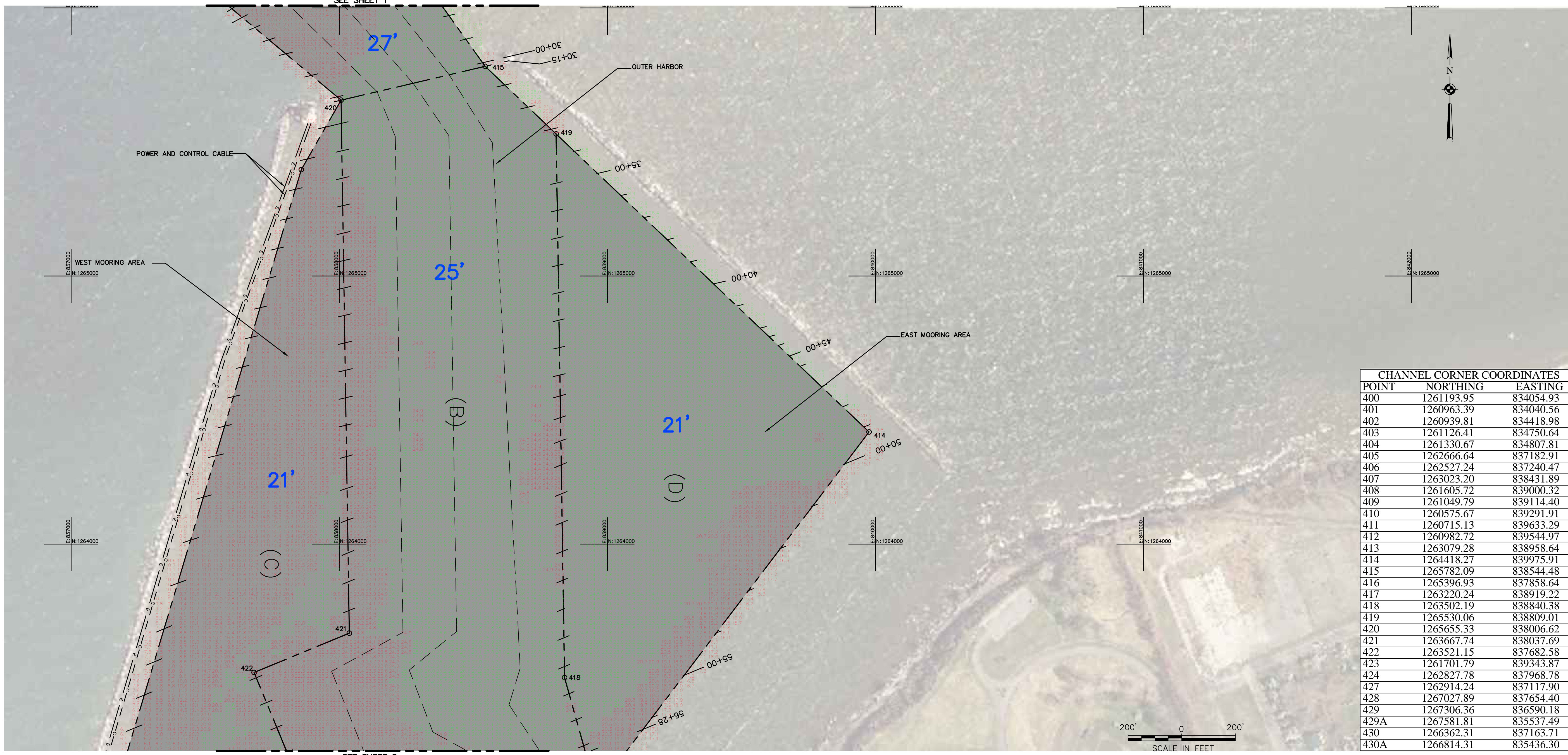
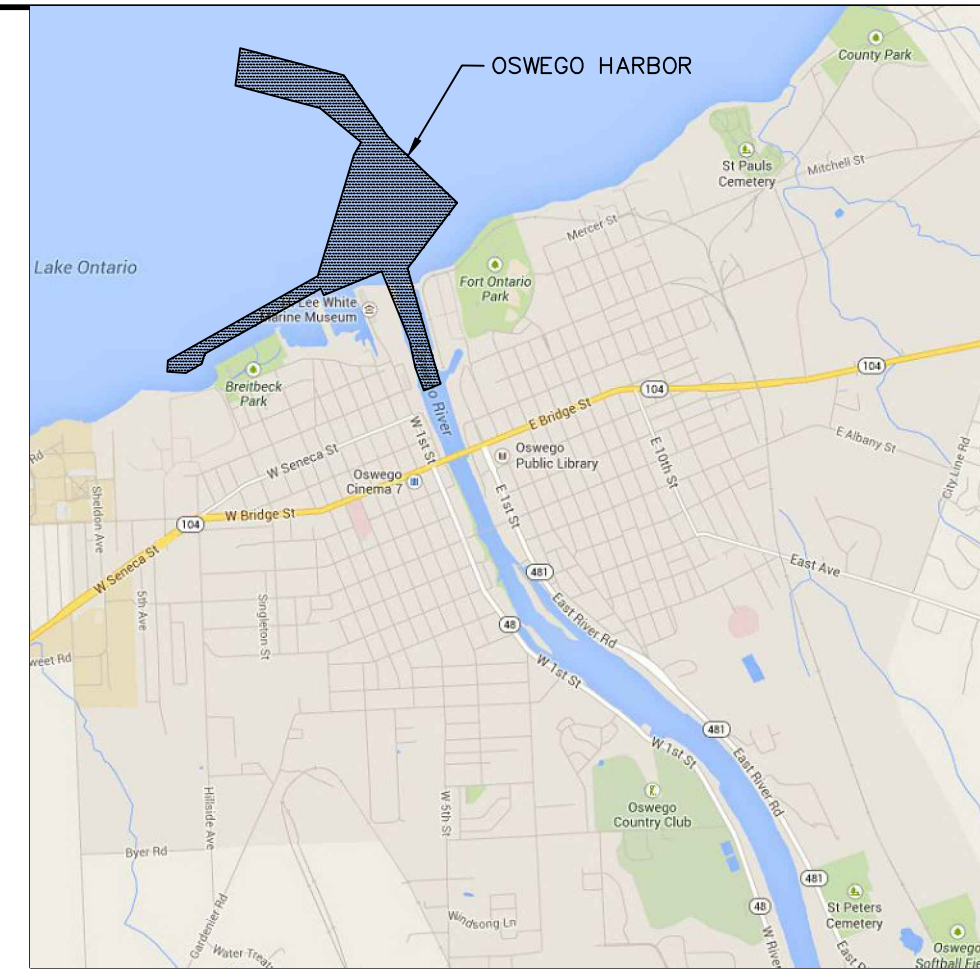

CHANNEL CORNER COORDINATES
POINT NORTHING EASTING
400 1261193.95 834054.93
401 1260963.39 834040.56
402 1260939.81 834418.98
403 1261126.41 834750.64
404 1261330.67 834807.81
405 1262666.64 837182.91
406 1262527.24 837240.47
407 1263023.20 838431.89
408 1261605.72 839000.32
409 1261049.79 839114.40
410 1260575.67 839291.91
411 1260715.13 839633.29
412 1260982.72 839544.97
413 1263079.28 838958.64
414 1264418.27 839975.91
415 1265782.09 838544.48
416 1265396.93 837858.64
417 1263220.24 838919.22
418 1263502.19 838840.38
419 1265530.06 838809.01
420 1265655.33 838006.62
421 1263667.74 838037.69
422 1263521.15 837682.58
423 1261701.79 839343.87
424 1262827.78 837968.78
427 1262914.24 837117.90
428 1267027.89 837654.40
429 1267306.36 836590.18
429A 1267581.81 835537.49
430 1266362.31 837163.71
430A 1266814.31 835436.30

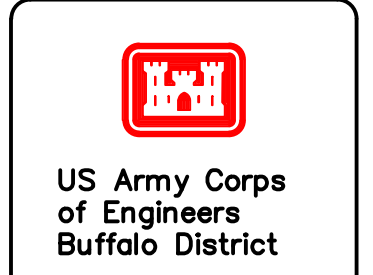

Table with 5 columns and 10 rows, likely for drawing or revision tracking.

Drawn by: KPL
Checked by: ACK
Reviewed by: Roman H. Figler III PLS
Chief, Survey Section
Approved by: Edward F. Goweracki
Date: May 5, 2014
Chief, NY/PA Navigation and Maintenance Section
http://www.fhooos.army.mil/library/NavigationCharts.aspx

U.S. ARMY ENGINEER DISTRICT
CORPS OF ENGINEERS
BUFFALO, NEW YORK 14207-3199

OSWEGO HARBOR, NY
PROJECT CONDITIONS SOUNDINGS 2014
SCALE: 1"=200'

Sheet reference number
VH-102
Sheet 2 of 3

D:\Survey Drive Projects\NY-Oswego Harbor\Drawing Files (Cadd)\Oswego 2014.dwg

To download an electronic version of this map, point a web browser to http://www.fhooos.army.mil/library/NavigationCharts.aspx